

SNP-3160

65W Universal AC Input Power Supply

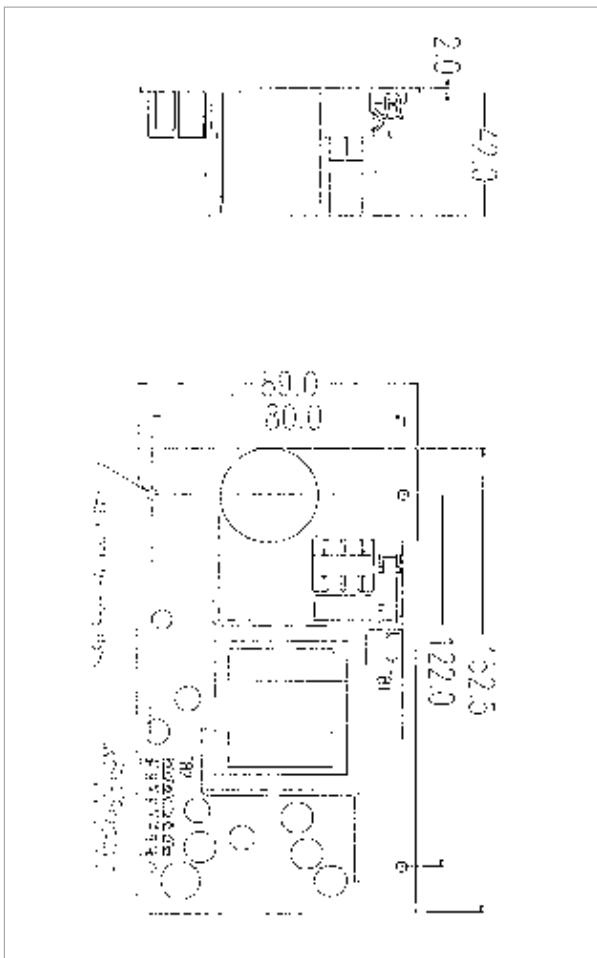

Mechanical Drawing



FEATURES

- 0 to 50°C Operation temperature
- Typical efficiency is 70%
- Designed Comply with :
UL 478,1012 / CSA 22.2 / VDE 0806
- EMI meets FCC Class B

INPUT CHARACTERISTICS

- **Input Voltage:** 85V AC to 264V AC
- **Input Frequency:** 47Hz to 63Hz
- **Inrush Current (Cold):** 15A at 115V AC
30A at 230V AC

OUTPUT CHARACTERISTICS

Model No.	Output Voltage	Load			Tolerance	Ripple & Noise	Line reg.	Load reg.
		Min.	Rated	Max.				
SNP-3160	+5V	0A	5.5A	10A	4.95V~5.00V	50mV	1%	2%
	+12V	0A	2.5A	4A	11.8V~12.2V	100mV	1%	5%
	-12V	0A	0.5A	1A	-10.8V~13.2V	100mV	2%	8%
	-5V	0A	0.5A	1A	-4.5V~5.5V	50mV	2.4%	8%

SPECIFICATION

- **Holdup Time:** 20ms
- **Overvoltage Type:** Crowbar Trip point 5.7V to 7V
- **Overload Protection:** Fold back
- **Switching Frequency:** >30KHz